

# MINI STEP MOTOR

## 1011BY

### Permanent Magnet

Applications: Security system, office automation system, medical equipment, mini household appliance, toys and so on.

#### Characteristics

		1011BY	
1	No. of phase		2
2	Excitation Mode		2-2
3	Voltage	V	5
4	Resistance	$\Omega$	15
5	Step Angle	Deg	18°
6	Current	A	0.3
7	No-load Pull-in Frequency	pps	1400
8	No-load Pull-out Frequency	pps	2500
9	Detent Torque	mNm	0.1
10	Pull-in Torque	mNm	0.4
11	Load pull-in Frequency	pps	500
12	Weight	g	5.5
13	Operating temperature range	°C	-20~+100

#### Outline Drawing

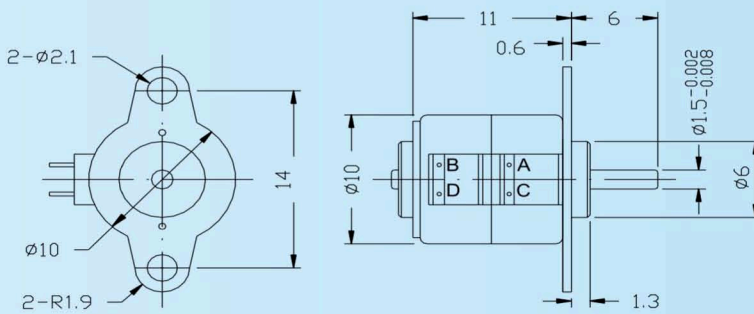

UNIT:mm

#### Sequence Diagram

Excitation Mode 2-2

CCW →

PIN	Step 1	Step 2	Step 3	Step 4
A	+	-	-	+
C	-	+	+	-
B	+	+	-	-
D	-	-	+	+
Phase	a,b	-a,b	-a,-b	a,-b

← CW

#### Wiring Diagram

