

# 2914ZW

## Outer Rotor With Sensor

Applications: Precision driving field in medical equipment, industrial automation, etc.

### Characteristics

			-1-24.0	
1	Voltage	V	24	
2	Terminal resistance	$\Omega$	12.00	
3	No-load speed	rpm	5500	
4	No-load current	A	0.1	
5	Stall torque	mNm	75	
6	Stall current	A	2	
7	Nominal torque	mNm	27.5	
8	Nominal speed	rpm	3500	
9	Nominal current	A	0.8	
10	Max. output power	W	10	
11	Max. efficiency	%	60	
12	Back-EMF constant	mV/rpm	4.1	
13	Torque constant	mNm/A	40	
14	KV Value	rpm/V	230	
15	Speed/torque gradient	rpm/mNm	73	
16	Rotor inertia	gcm <sup>2</sup>	23	
17	Weight	g	51	
18	Thermal resistance housing-ambient	K/W	6	
19	Thermal resistance winding-housing	K/W	11	
20	Thermal time constant motor	s	160	
21	Thermal time constant winding	s	15	
22	Operating temperature range	$^{\circ}\text{C}$	-40~+100	
23	Max. winding temperature	$^{\circ}\text{C}$	155	
24	Axial play	mm	0.012	
25	Radial play	mm	0.02	
26	Axial load dynamic	N	1.5	
27	Axial load static	N	37	
28	Radial load at 3 mm from mounting face	N	12	
29	No. of pole pairs		6	
30	Bearings		2 ball bearings	
31	Commutation		Hall Sensor	
32	Protection class		IP 20	

### Options

- Lead wires length
- Shaft length
- Special coils
- Gearheads
- Bearing type
- Hall sensor
- Encoder
- Driver

### Outline Drawing

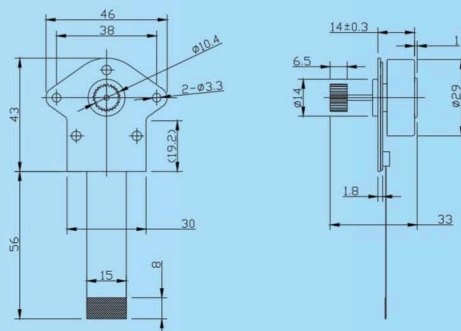

UNIT:mm