

4326ZWW

Outer Rotor Without Sensor

Applications: UAV gimbals and handheld gimbals

Characteristics

			-1-24.0
1	Voltage	V	24
2	Terminal resistance	Ω	0.6
3	Terminal inductance	mH	0.5
4	No-load speed	rpm	6100
5	No-load current	A	0.3
6	Nominal torque	mNm	140
7	Nominal speed	rpm	5500
8	Nominal current	A	4
9	Max. output power	W	237
10	Max. efficiency	%	83
11	Back-EMF constant	mV/rpm	3.9
12	Torque constant	mNm/A	37
13	Speed/torque gradient	rpm/mNm	4.1
14	Rotor inertia	gcm ²	181
15	Weight	g	135
16	Thermal resistance housing-ambient	K/W	6.3
17	Thermal resistance winding-housing	K/W	6
18	Thermal time constant motor	s	200
19	Thermal time constant winding	s	40
20	Operating temperature range	°C	-40~+100
21	Max. winding temperature	°C	155
22	Axial play	mm	0.012
23	Radial play	mm	0.008
24	Axial load dynamic	N	8
25	Axial load static	N	85
26	Radial load at 3 mm from mounting face	N	26
27	No. of pole pairs		8
28	Bearings		2 ball bearings
29	Commutation		Sensorless
30	Protection class		IP 30

Options

- Lead wires length
- Shaft length
- Special coils
- Gearheads
- Bearing type
- Hall sensor
- Encoder
- Driver

Outline Drawing

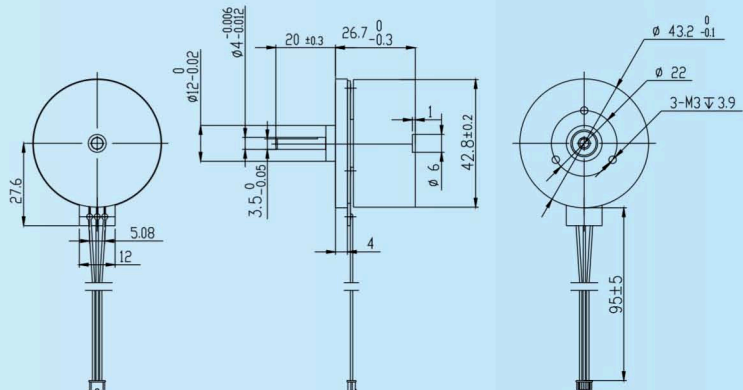

UNIT:mm